



## 21 High Delf Way

Whitecroft, Lydney, GL15 4RW

£280,000





**NO ONWARD CHAIN!!** If you are looking for a lifestyle choice of semi-rural living yet within 10 minutes drive of the town of Lydney then take a look at this two bedroom detached bungalow near to a serene woodland area.

A modern looking property positioned on a level plot of ground, this bungalow offers numerous parking spaces down to the garage, private rear gardens with views over to woodland. This detached bungalow offers the perfect blend of privacy and natural beauty.



#### Entrance Hallway:

6'0" x 2'11" (1.84m x 0.91m)

Front door to hallway with lighting and a radiator.

#### Lounge:

19'3" x 10'7" (5.88m x 3.24m)

Two radiators, lighting, tv point and sliding doors to the rear elevation.

#### Hallway:

3'1" x 10'4" (0.95m x 3.17m)

With power and lighting, thermostat, storage cupboard and loft access.

#### Kitchen:

10'0" x 7'3" (3.05m x 2.22m)

UPVC double glazed window to side access, single sink and drainer unit, base and eye level units, oven, hob and extractor fan, power and lighting, integrated fridge and freezer.

#### Bathroom:

5'6" x 6'4" (1.68m x 1.95m)

WC, sink, radiator, hand rail, mirror and storage cabinet, UPVC double glazed window, bathtub with shower hose, lighting.

#### Bedroom One:

8'3" x 15'1" (2.52m x 4.61m)

Double bedroom with built in wardrobes. UPVC double glazed bay window to front aspect, large radiator, power and lighting, electric shower cubicle, TV point.

#### Bedroom Two:

8'10" x 9'5" (2.71m x 2.88m)

Double bedroom, UPVC double glazed window to front aspect, power and lighting, radiator, built in storage.

#### Outside;

The rear garden is laid to lawn with a raised flower bed, side patio and stepping stones leading to the shed, outside lights. Outside tap to the side of the house and lighting.

Garage with up and over door, lighting and power.

The front garden is laid to lawn with off road parking for numerous vehicles.



Consumer Notes: Dean Estate Agents Ltd have prepared the information within this website/brochure with care and co-operation from the seller. It is intended to be indicative rather than definitive, without a guarantee of accuracy. Before you act upon any information provided, we request that you satisfy yourself about the completeness, accuracy, reliability, suitability or availability with respect to the website or the information, products, services, or related graphics contained on the website for any purpose. Confirmation of the title, boundary plan, sellers situation must be confirmed with you before any expense is incurred.

If there are any changes to the fixtures, fittings and relevant aspects of the property since the commencement of marketing, we have asked the vendor to notify us immediately. Please also confirm to your satisfaction the services connected to the property and any planning consents. These details do not constitute any part of any Offer, Contract or Tenancy Agreement.

Photographs used for advertising purposes may not necessarily be the most recent photographs. Any reliance you place on such information is therefore strictly at your own risk. All photographic images are under the ownership of Dean Estate Agents Ltd and therefore Dean Estate Agents Ltd retain the copyright. You must obtain permission from the owner of the images to reproduce them.

Tenanted Property – we are not always able to show the most recent condition of a property due to tenants' privacy and we may choose to show the photographs of the property when it was last vacant to at least allow clients some idea of the internal condition. Therefore, we would of course, urge you to view the property before making any decisions to purchase or rent the property and before committing to any costs. An offer to purchase any property will be considered after a physical viewing has taken place.

Energy Performance Certificates are supplied to us via a third party and we do not accept responsibility for the content within such reports.

Road Map



Hybrid Map



Terrain Map



Floor Plan

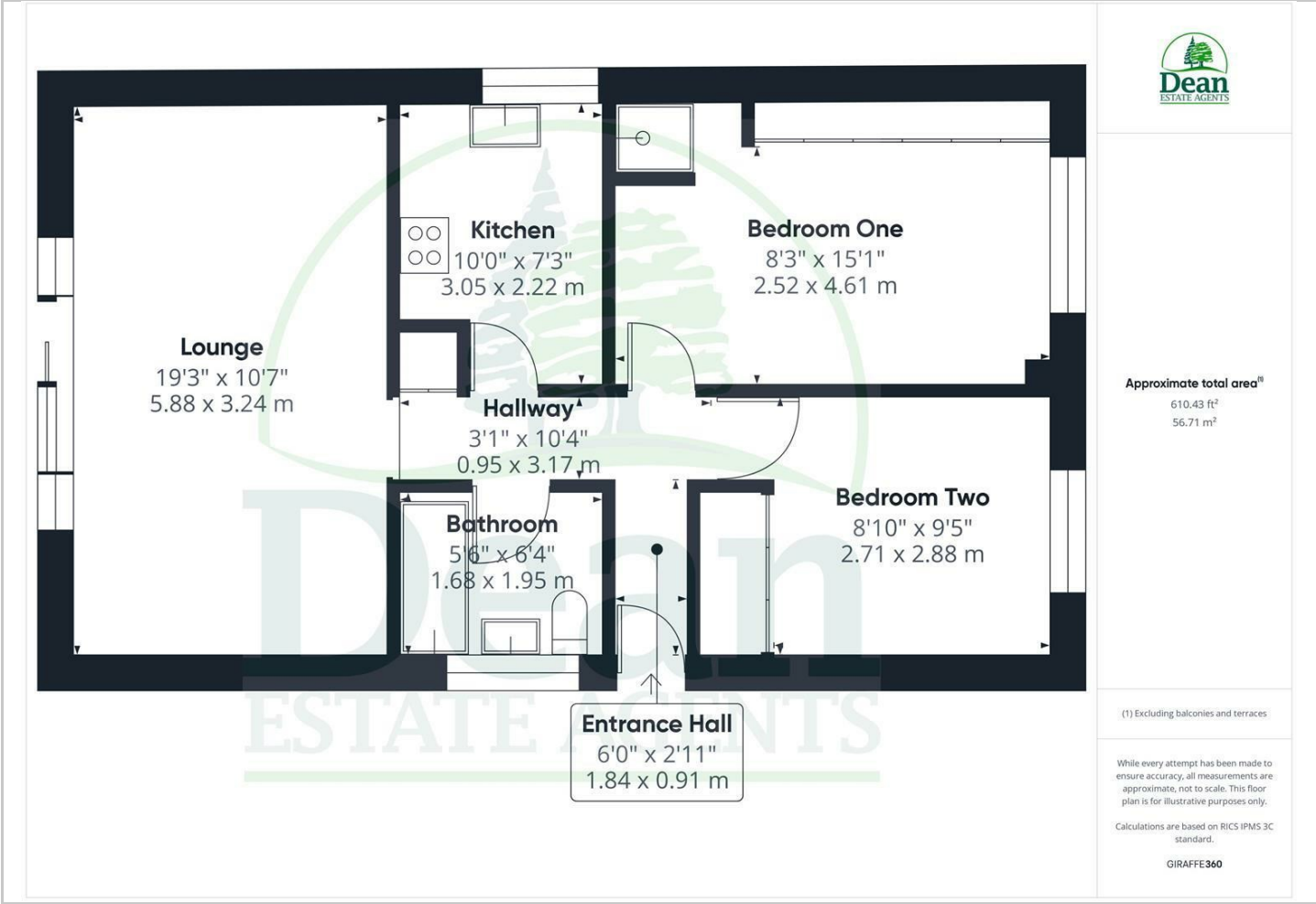

Viewing

Please contact our Lydney Office on 01594 368202 if you wish to arrange a viewing appointment for this property or require further information.

Energy Efficiency Graph

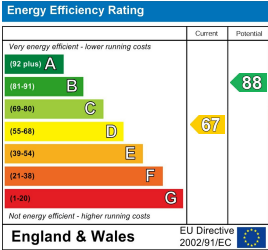

These particulars, whilst believed to be accurate are set out as a general outline only for guidance and do not constitute any part of an offer or contract. Intending purchasers should not rely on them as statements of representation of fact, but must satisfy themselves by inspection or otherwise as to their accuracy. No person in this firms employment has the authority to make or give any representation or warranty in respect of the property.